



AS-100

智慧型節能揭門式洗碗碟機

SMART ENERGY SAVING DOOR-TYPE DISHWASHER



創新技術 · 智慧管理 · 成本銳減 · 效益倍增

Connecting Innovation & Smart Technology to Drive Cost Savings & Maximise Operational Efficiency

AS-100

產品描述 Product Description

CHAMPION AS-100 智慧型節能揭門式洗碗碟機，搭載多項專利技術與智慧管理系統，提供符合國際標準的高效清潔效能。以永續綠色營運模式，助您輕鬆應對繁忙清洗需求，為現代餐飲業實現最大成本效益。

The CHAMPION AS-100 is an energy-efficient door-type dishwasher featuring multiple patented technologies and a smart management system, offering high cleaning efficiency that meets international standards. It optimizes cost-effectiveness for the modern food and beverage industry while supporting your green operational goals.

為什麼選擇 AS-100 ? Why to choose AS-100 ?



- | | |
|---------------------|---|
| 省成本
Cost Savings | : 每年節省能源費用超過 52%，同時降低人力管理成本
Save over 52% on energy costs annually while reducing labor management expenses |
| 省時間
Time Savings | : 智慧故障診斷與遠端維護功能，提升維護效率
Smart fault diagnosis and remote maintenance features enhance maintenance efficiency |
| 省心
Peace of Mind | : 原廠保養及售後維護，確保及時全面的技術及零件支援
Genuine warranty coverage ensures timely and comprehensive technical and parts after-sales services and support |

創新技術 · 提升效能

Cutting-edge Technology • Enhanced Cost Effectiveness



靜磁™智能變頻主洗泵

消除傳統機械軸承摩擦，有效減少流體阻力，輸出馬力比傳統電機提升高達150%，透過動態調整轉速，實現十段清洗力度精細調節，滿足多樣化清洗需求，同時採用先進的氧化鋯陶瓷密封技術，有效降低故障率及能耗，提升整體效能

CleanMag™ Smart Motorpermanent

Eliminates friction from traditional mechanical bearings, effectively reducing fluid resistance, and achieve an 150% increment in output power compared to the traditional motors. Dynamic speed adjustment allows for ten levels of cleaning intensity control, meeting diverse cleaning needs. Utilising advanced zirconia ceramic sealing technology, it effectively lowers failure rates and energy consumption while optimizing overall performance

CHAMP-BOX™無觸式繼電器

抗濕氣設計，穩定耐用，避免傳統繼電器因氧化導致接觸不良，在極端環境中仍能穩定工作

CHAMP-BOX™ Contactless Relay

Humidity-resistant design for stability and durability. Prevents oxidation-related contact failure, ensuring reliable operation in extreme environments

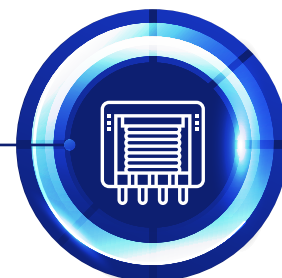

CHAMP-X™活塞脈衝陶瓷智能分配器

採用油井抽取原油的往復式活塞泵技術，並以高硬度的氧化鋯陶瓷作為主材，實現0.1ml精準分配，大幅降低清潔劑浪費，輕鬆維持穩定高效的清洗效果，壽命高達10年

CHAMP-X™ Smart Pulsed Signal Injector

Utilises reciprocating piston pump technology commonly used in oil well extraction, with high-hardness zirconia ceramic. Delivers precise 0.1ml dispensing, significantly reducing detergent waste while maintaining efficient cleaning results, with a lifespan of up to 10 years

靜研™大氣壓傳感液位儀

採用大氣壓力計算水位高度，精準控制水位及減少水質干擾，以及提供信號感測換水密度，以便監察衛生操作程序

CleanNovation™ Atmos Sensor

Using atmospheric pressure to calculate water level height, it enables precise water level control and minimises water quality interference. Additionally, it provides signal sensing for changes in water density, ensuring effective monitoring of sanitary operating procedures





電源節省
Electricity saving

	普遍機型 General Model	AS-100	節省 Save
每小時用電量 Electricity Consumption per hour	9 kWh	4.2 kWh	52%

每日運作
Daily Operation Time 8小時(hour)

賺取高達
Possible Earn **\$1500 / 月**
Month



供電需求減少
Power Supply Requirement Reduction

傳統機型 General Model	▶ 30 Amp
AS-100	▶ 15 Amp



用水量節省
Water Consumption Saving

傳統機型 General Model	▶ 3 Ltr / 節(Rack)
AS-100	▶ 1 Ltr / 節(Rack)

減碳首選
PREMIUM ENERGY EFFICIENCY,
CARBON REDUCTION CHAMPION

以上資料根據香港生產力促進局驗證 (項目編號: 00390)。
 The above information is based on the testing result of Hong Kong Productivity Council (Project Number 00390).

以上數據只作參考用途，節省率會受實際環境及操作所影響。
 The above data is for reference purposes only. The saving is affected by actual environment and washing procedure.

智慧管理 • 無憂運營
Smart Management • Seamless Operation



實時衛生監控
Real-time Hygiene Monitoring

▶ 實時監控洗滌過程，確保餐具衛生100%達標
 Tracks all the washing cycles to ensure 100% compliance with hygiene standards



維護服務管理
Service Management

▶ 智慧診斷異常，提前預警，減少停機風險
 Intelligent diagnosis with early abnormality warning to minimise downtime risks

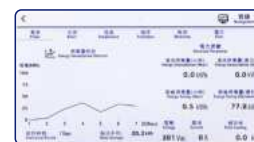

營運資源管理
Resources Management

▶ 智能監控能源及清潔劑用量，優化成本控制
 Smart tracking of energy and detergent consumption to optimise cost control



中央管理多台設備
Centralised Management of Multiple Devices

▶ 透過電腦掌握設備狀態，生成洗滌報告，便於管理
 Remotely monitor and manage multiple equipment status through network connectivity, enabling efficient centralised control

高效清潔 • 衛生保障
High Cleaning Efficiency • Hygiene Assurance



360°立體噴淋
360° Stereo Rinsing System

▶ 上下雙噴臂搭配特殊噴嘴，徹底清除頑固污漬，全方位確保清潔效果
 Dual spray arms (top and bottom) paired with specialised nozzles thoroughly remove stubborn stains, ensuring complete cleaning coverage



多重洗滌模式
Multiple Washing Modes

▶ 標準模式、重污模式及除垢程序，靈活應對多樣化需求
 Includes standard, heavy stain, and descaling modes, offering flexible solutions to meet diverse needs



HACCP 國際認證

清洗程序符合HACCP食品安全標準，確保餐具衛生，讓客人享受安全無憂的用餐體驗

HACCP Certification

The cleaning procedures comply with HACCP Food Safety Program, ensuring clean tableware and providing customers with extraordinary dining experience



環保清潔劑

搭配原廠並獲中國環境標誌產品認證清潔劑

Eco-friendly Cleaning Detergents

Compatible with China Environmental Labelling Certified genuine cleaning detergents

透視圖 Perspective

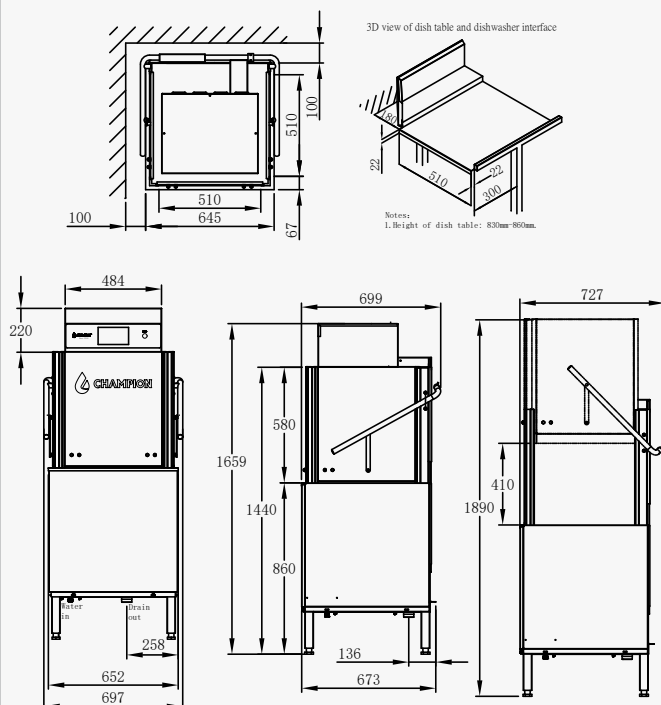

運作圖 Operation Diagram



標準式運作圖
Standard Type Operation

牆角式運作圖
Corner Type Operation

技術規格 Technical Data

洗滌時間 Cycle Time	1 Min
最大洗滌量 Maximum Capacity	60 Racks / Hour
用水量 Water Consumption	1-1.2 L / Rack
主洗水缸 Wash Tank	24 L
主洗缸發熱線 Tank Heat	3 kW
熱水爐 Booster	5 kW
主洗泵 Wash Pump	0.75 kW (CleanMag™ Smart Motor permanent)
總功率 Total Loading	9 kW (15 Amp)
尺寸 Loading Size	697 (W) x 699 (D) x 1659 (H) mm
開門高度 Opening Height	1890 mm
檯面高度 Countertop Height	860 mm
最高洗滌高度 Loading Height	410 mm
重量 Weight	132 Kg

安裝和連接要求 Installation and Connection Requirements

供水管 Supply Hose	3/4"
水壓 Water Pressure	15 - 20 psi
排水管 Drain Hose	OD 40 mm
供電 Power Supply	380 V / 50 Hz / 3 / N / PE / 15 A (防水隔離開關 Weatherproof Isolator)
電源線 Power Cord	3-5 mm ²

選項和配件 Options and Accessories

洗碗碟機專用篩 Dishwasher Rack	500 x 500 mm
-------------------------	--------------

售後服務才是我們的開始

After-Sales Service is Where Our Business Begins



預防性檢查

Preventive
Inspections



衛生諮詢及培訓

Hygiene Consultation
and Training



原廠保養

Genuine Warranty
Service



流動工程車隊

Engineering
motorcade



全面售後支援

Comprehensive
After-sales Support



CHAMPION®

We Make · We Care 我創造 · 我重視



V2.25.4.2.AS100